



AMORIM

AMORIM ISOLAMENTOS, S.A.

# 100% NATURAL

M A N U F A C T U R I N G P R O C E S S



① Forest



② Harvest



③ Mechanical/manual cork removal



④ Stock



⑤ Grinding



⑥ Autoclave agglomeration



⑦ Stabilization



⑧ Squaring and cutting



⑨ Packing and expedition

## Expanded Insulation Corkboard

Technical features:

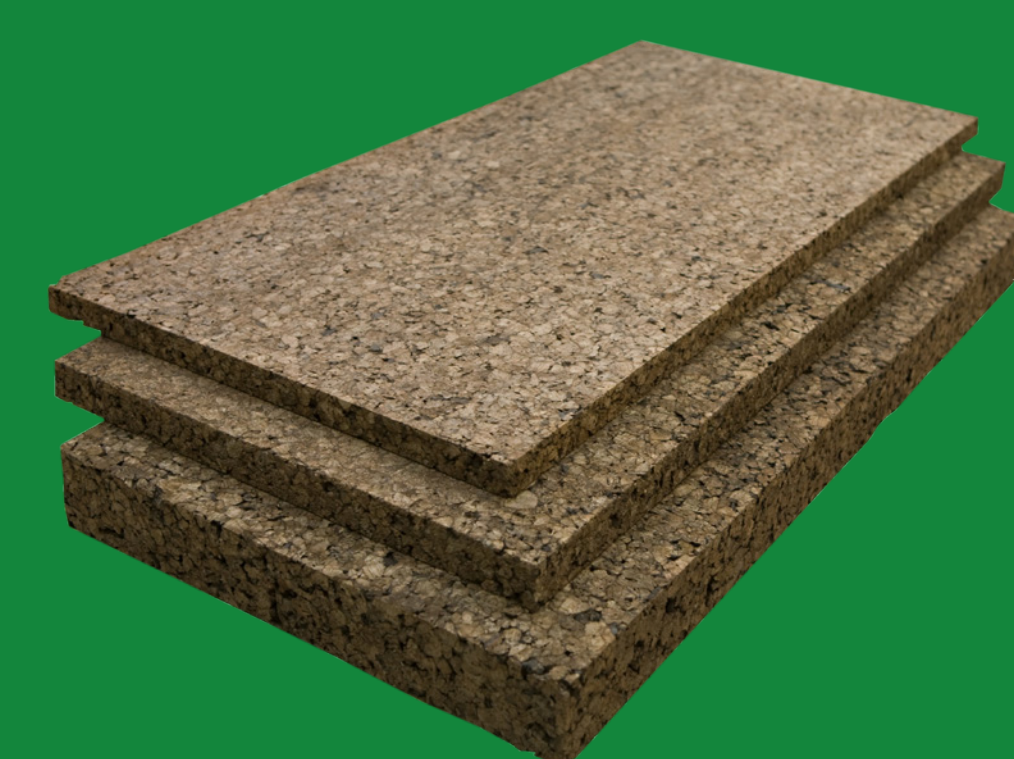

- > **Density:** 100/120 kg/m<sup>3</sup>.
- > **Thermal conductivity:** test results range between 0.036/0.038 W/mk.
- > **Value declared for EU label:** 0.040W/mk.
- > **Compression resistance at 10%:** declared 100 KPa (test results 110/120 KPa) - EN 826.
- > **Perpendicular face resistance:** declared TR50 (test results 60 KPa) - EN 1607.
- > **Maximum moisture content:** 8% - EN 1215.

- > **Water absorption:** declared 0.5 Kg/m<sup>2</sup> (maximum test result 0.3 kg/m<sup>2</sup>) - EN 1609.
- > **Length tolerance:** between +/- 3 and 5mm - EN 822.
- > **Width tolerance:** between +/- 2 and 3mm - EN 822
- > **Thickness tolerance:** between +/- 1 and 2 mm - EN 823.
- > **Fire resistance:** Euro class "E" - EN 13501 - 1.
- > **Durability:** practically unlimited.
- > **Impact noise:** 20dB LF - 40 dB MF - 30dB HF.
- > **Air noise:** 30dB LF - 35 dB MF - 34dB HF.

- > **50mm Sound absorption:** 40% at 400 Hz / 50 % at 3500 Hz
- > **Sound speed on cork:** 500 m/second.
- > **Sound absorption coefficient 500 CPS:** 0.33/0.35.
- > **Dimensions:** 1000x500mm (other size upon request)
- > **Thickness:** 10 to 320mm (Standard material)
- > **Moisture factor resistance:** MU 20



[WWW.AMORIMISOLAMENTOS.COM](http://WWW.AMORIMISOLAMENTOS.COM)

Rua da Corticeira, nº66, 4535-173 Mozelos VRF, Portugal  
TEL (+351) 227 419 100 | EMAIL [geral.aisol@amorim.com](mailto:geral.aisol@amorim.com)

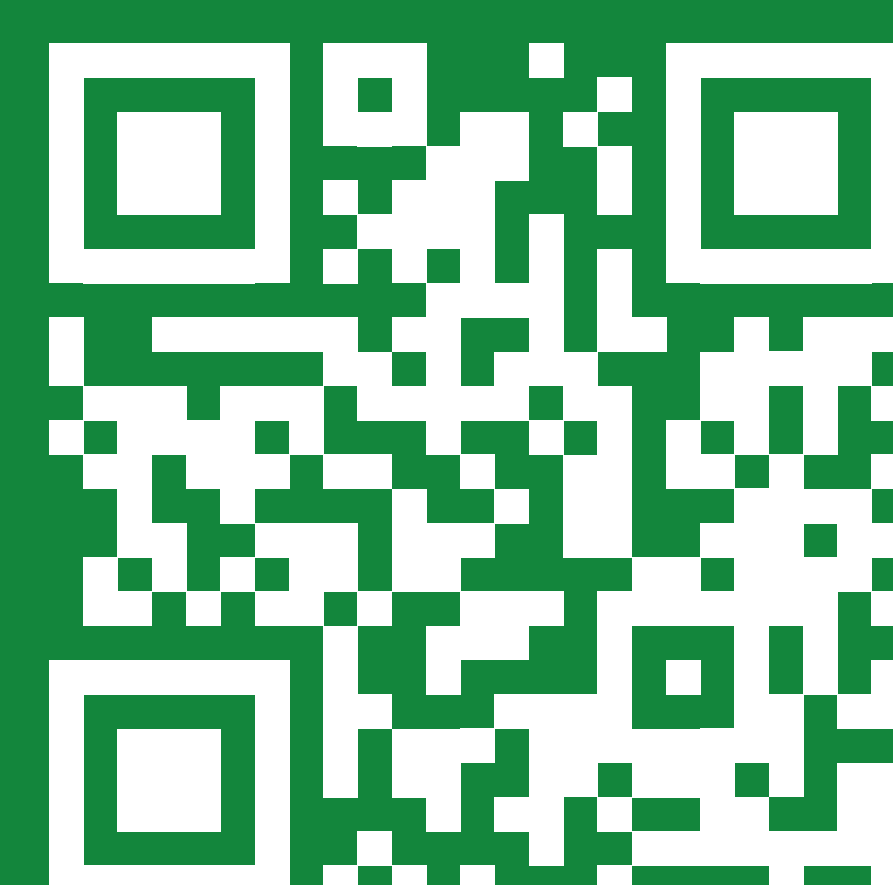





AMORIM

AMORIM ISOLAMENTOS, S.A.

# APPLICATIONS

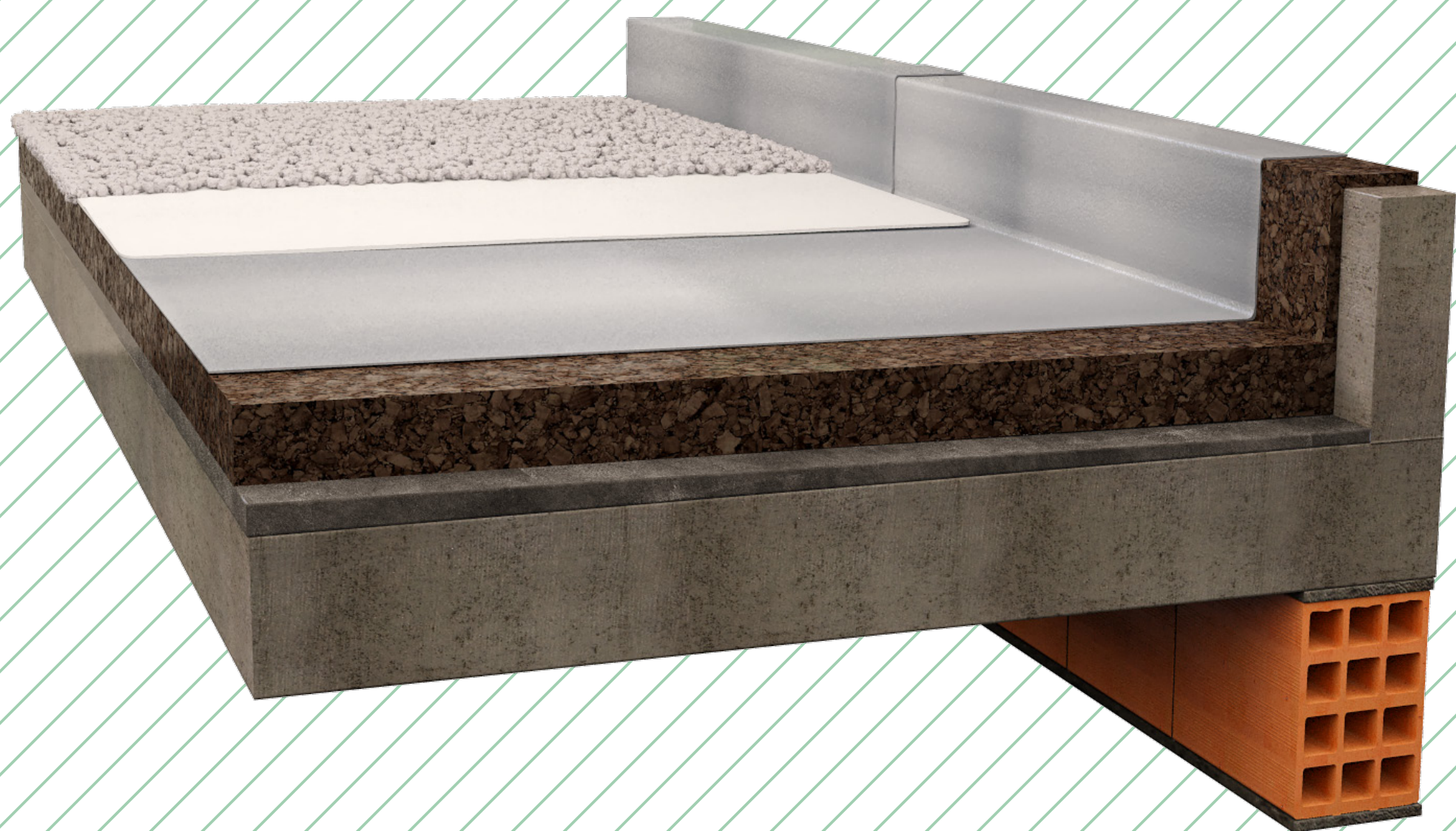

④ TRADITIONAL  
FLAT ROOF



④ PITCHED ROOF WITH  
CORRUGATED ROOFING SYSTEM



④ RENOVATION WITH  
LAMBOURDE FOR SUPPORT FOR  
NAILED FLOORING AND GYPCORK

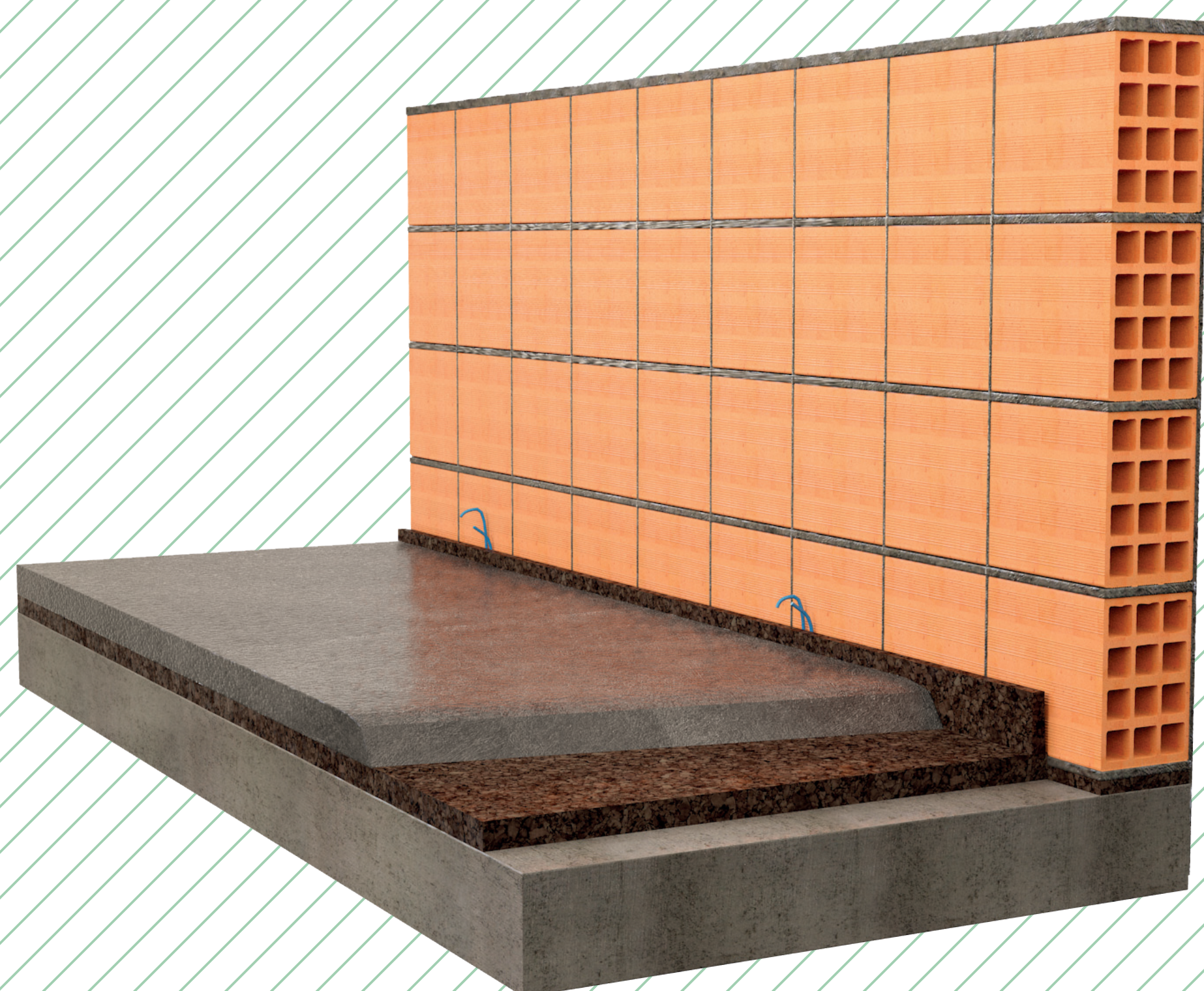

④ UNLINKING SCREED  
FILLER TO THE WALL



④ INTERNAL PARTITIONS WITH  
INSULATION LINED ON BOTH SIDES



④ VENTILATED  
FACADE

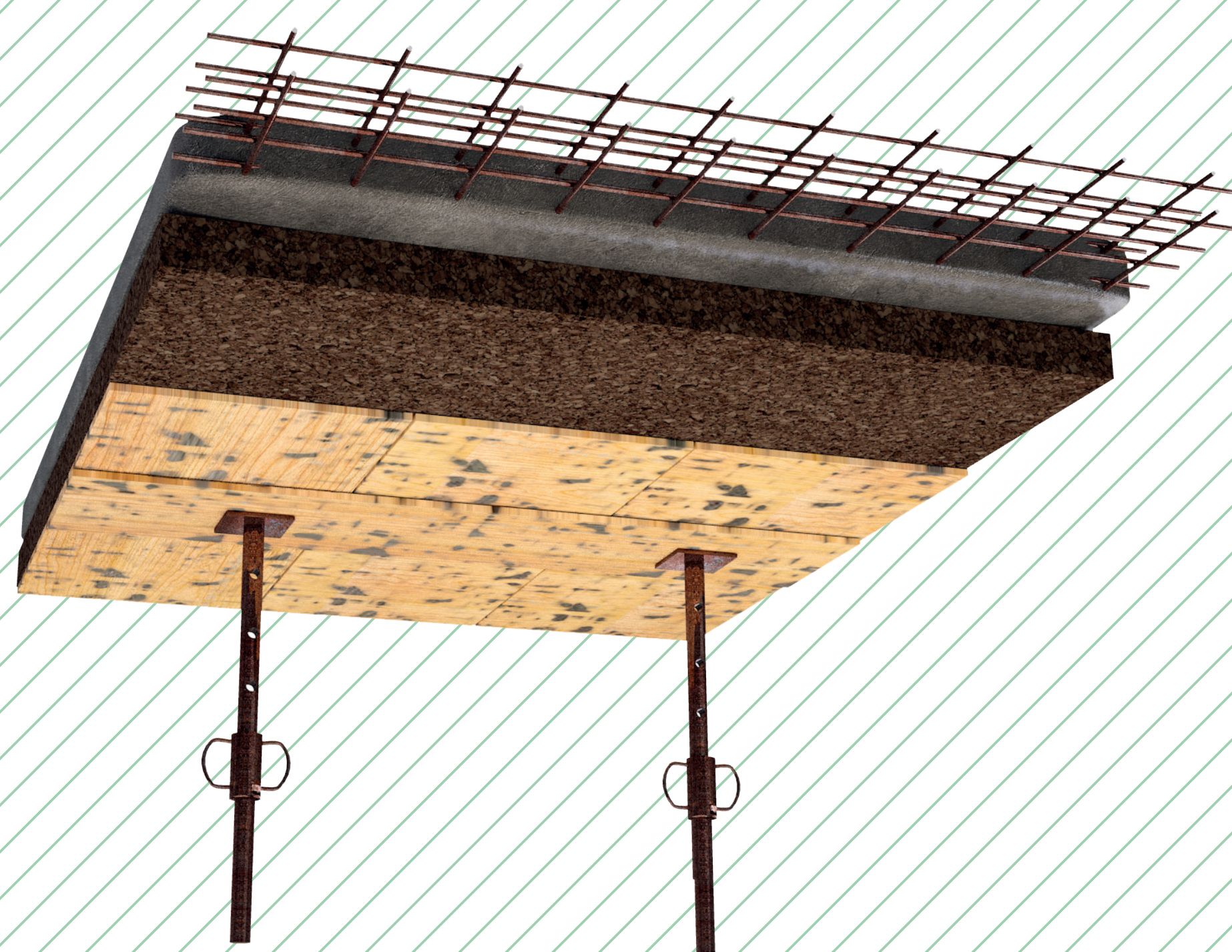

④ FORMWORK  
INSULATION



④ DOOR CORE  
INSULATION

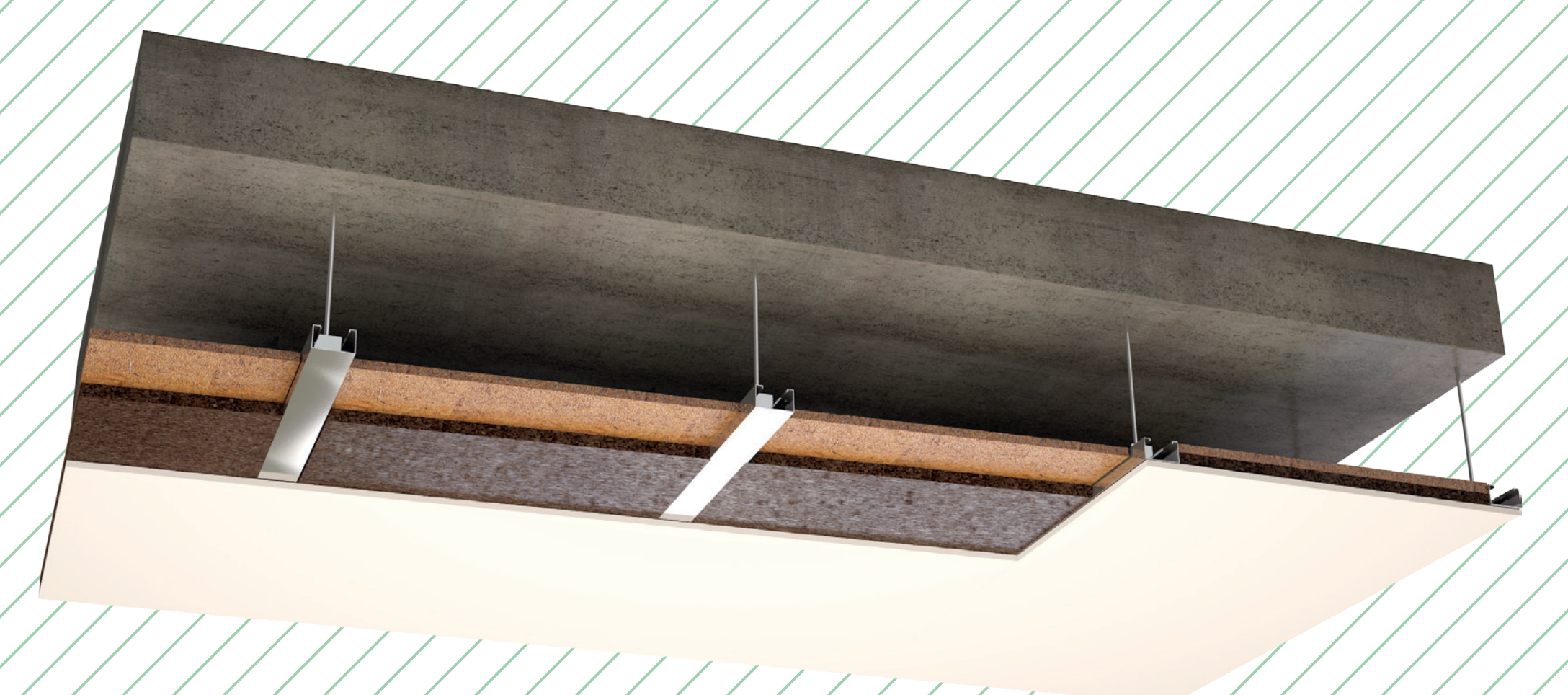

④ ACOUSTIC  
FALSE CEILING



[WWW.AMORIMISOLAMENTOS.COM](http://WWW.AMORIMISOLAMENTOS.COM)

Rua da Corticeira, nº66, 4535-173 Mozelos VRF, Portugal  
TEL (+351) 227 419 100 | EMAIL [geral.aisol@amorim.com](mailto:geral.aisol@amorim.com)

